

A

B

C

D

We reserve all rights in this document and in the information contained therein. Reproduction, use or disclosure to third parties without express authority is strictly forbidden.
 © ABB Oy, Machines, Helsinki

General tolerances ISO 2768-mK
 Threads according to ISO 965 tolerance class 6H
 Symbols for roughness acc. to ISO 1302

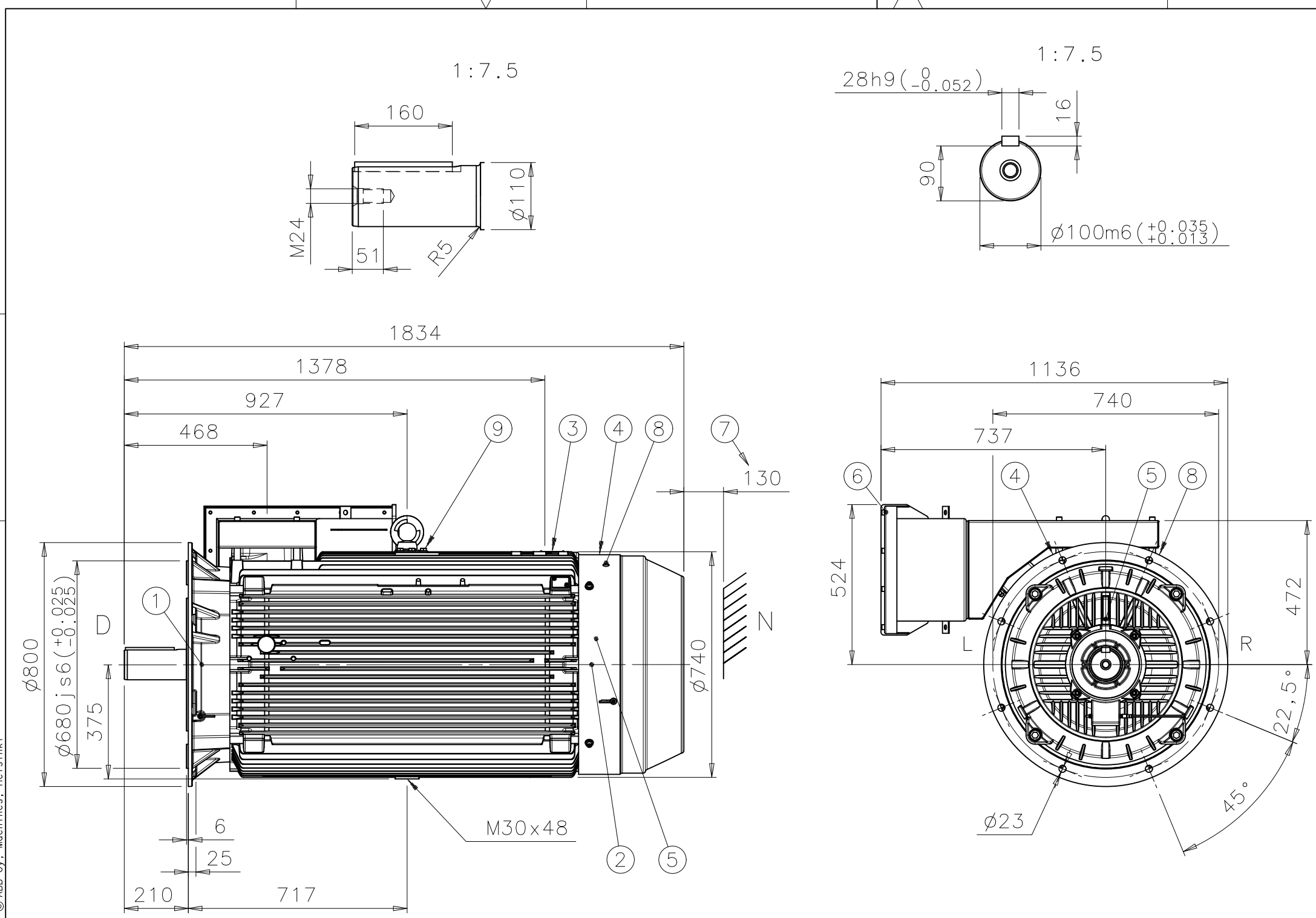

| | | |
|---|---|---------|
| 1 | D-BEARING | 6322/C3 |
| 2 | N-BEARING | 6316/C3 |
| 3 | TERMINAL BOX FOR CONTROL CABLE $\phi 10-14$, 2xM20x1,5 | |
| 4 | SPM NIPPLE DE AND NDE | |
| 5 | PT-1000 FOR BEARINGS (OPTIONAL) | |
| 6 | MAIN TERMINAL BOX | |
| 7 | FREE DISTANCE FOR COOLING | |
| 8 | GREASING NIPPLE DE AND NDE | |
| 9 | EARTHING, M12, FOR M3GM MAX 150mm ² | |

A

B

C

D

THE CUSTOMER IS RESPONSIBLE FOR THE DESIGN AND CONSTRUCTION OF THE FOUNDATION. IT SHALL BE SUFFICIENTLY RIGID TO WITHSTAND SHORT CIRCUIT FORCES. TO AVOID RESONANCE VIBRATIONS THE FOUNDATION SHALL BE DESIGNED SO THAT THE NATURAL FREQUENCY OF FOUNDATION TOGETHER WITH MACHINE IS NOT WITHIN $\pm 20\%$ OF RUNNING SPEED FREQUENCY. THE CUSTOMER IS ALSO RESPONSIBLE FOR LATERAL AND TORSIONAL CRITICAL SPEED ANALYSIS OF THE COMPLETE INSTALLATION.

| | | | | |
|--------------------------------------|--------------------------|-------------------|----------------------|----------|
| B DIMENSIONING REVISED, M3BM→M3BM/GM | | 2006-10-23 | AK | OL |
| Rev | Change | Date | Prep. | Approved |
| Prepared | 2005-03-31 M.KOSKINEN | Responsible dept. | ATAP/PID | |
| Approved | 2005-09-02 J.KARJALAINEN | Take over dept. | | |
| Material | | Code | 13 BM 355 A / 355 | |
| Supersedes | | Superseded by | M3BM/GM 355LK4-12 B5 | |
| ABB Oy, Machines, Helsinki | | Document No. | Revision | Sheet |
| | | 3GZF500035-470 | B | 1/1 |

1

2

3

4

5

6