

ZX ファミリー

ガス絶縁特高スイッチギヤ
(12 kV/24 kV/36 kV)

Gas-insulated medium voltage switchgear



ABB

- 金属閉鎖形
- 圧力密封式
- SF₆ガスによる優れた絶縁耐力
- 充電部を金属板で間仕切り
- ケーブル、母線とVTはプラグイン方式
- ステンレス製外箱
- 真空遮断器
- 工場出荷試験時の品質を維持

- Systems in metal-enclosed design
- Hermetically sealed pressure systems – gas-tight for life!
- SF₆ insulating gas for guaranteed dielectric strength
- Metal partitioning between functions where necessary
- Plug-in technology for cables, busbars and voltage transformers
- Enclosures in stainless steel
- Vacuum circuit-breakers
- Factory tested quality

ZX0

集合型及び単体型の2種の基本設計による、コンパクトな配電アプリケーション用システム。壁面設置。手動及び遠隔操作の両方が可能。真空遮断器とにフューズ付き(又は無し)スイッチ断路器。

Compact system for distribution applications in two basic versions: block and individual panel design. Installation against a wall. Both local manual operation and remote control are facilitated. Together with vacuum circuit-breakers, there are switch-disconnectors with and without fuses.

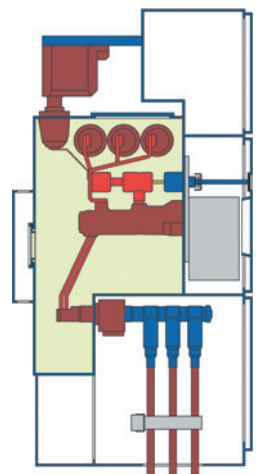
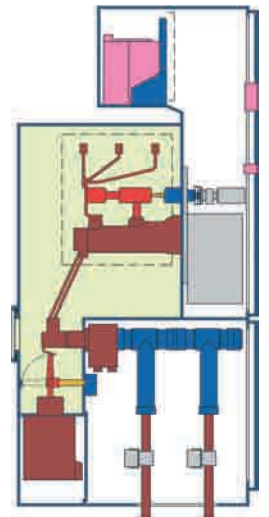

仕様 Technical data

定格電圧				
Rated voltage	kV	12	17.5	24
最高使用電圧				
Maximum operating voltage	kV	12	17.5	24
耐電圧(商用周波/雷インパルス)				
Test voltages	kV	28/75	38/95	50/125
定格周波数				
Rated frequency	Hz	50/60	50/60	50/60
定格母線電流				
Rated busbar current	A	...1250	...1250	...1250
遮断器付きフィーダーの定格電流				
Rated current of feeder with CB	A	...1250	...1250	...1250
負荷開閉器付きフィーダーの定格電流				
Rated current of feeder with load break switch	A	...630	...630	...630
定格ピーク耐電流				
Rated peak withstand current	kA	...63	...63	...63
定格短時間耐電流、3s				
Rated short-time current, 3s	kA	...25	...25	...25

ZX1.2

各種変電所向け単母線金属隔壁盤で、ケーブル接続位置を高くしている為、裏面からのケーブル設置工事が容易。全ての切替装置は遠方より操作が可能で、機械式インターロックも可能(オプション)。

Metalpartitioned single busbar system for transformer and distribution substations with raised cable terminations for ultra-simple cable installation from the rear. All switching devices can be remote controlled and optionally mechanically interlocked.

	IEC定格 IEC Ratings				特殊定格 Special Ratings	
定格電圧 Rated voltage	kV	12/17.5	24	36		
最高使用電圧 Maximum operating voltage	kV	17.5	24	36	40.5	
耐電圧(商用周波/雷インパルス) Test voltages	kV	38/95	50/125	70/170	85/185	
定格周波数 Rated frequency	Hz	50/60	50/60	50/60	50/60	
定格母線電流 Rated busbar current	A	...2500	...2500	...2500	...2500	
フィーダーの定格電流 Rated current of feeder	A	630 1250 ...2500	630 1250 ...2500	1250 ...2500	1250 ...2500	
定格母線電流 Rated peak withstand current	kA	62.5 ...80	62.5 ...80	...80	...80	
定格短時間耐電流、3s Rated short-time current, 3s	kA	25 ...31.5	25 ...31.5	...31.5	...31.5	

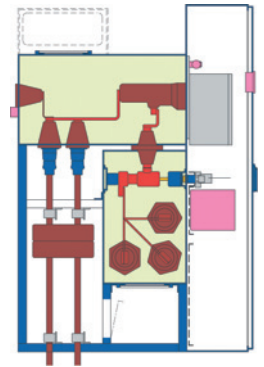

事故による内部アークの圧力解放はチャンネルまたは盤ごと

Alternatively with pressure relief channel or panelwise relief.

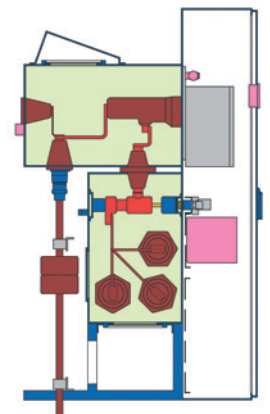
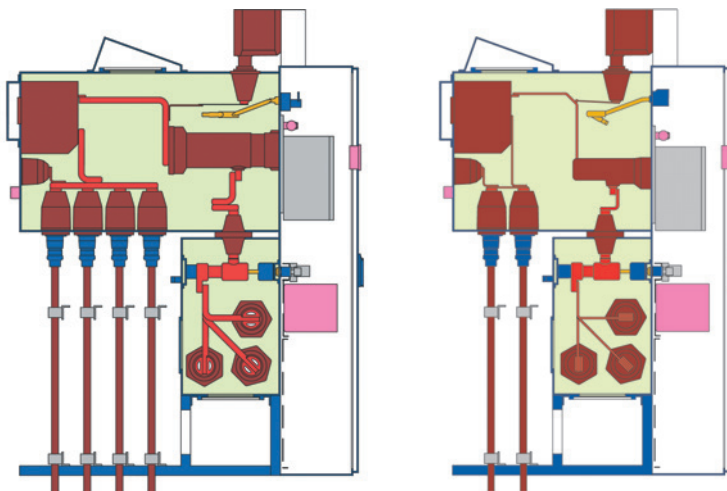

ZX2

高度な要求に応える、あらゆるアプリケーションに使用できる単母線または2重母線の金属隔壁盤。全ての切替装置は遠方より操作が可能で、機械式インターロックもオプション設定。複合マルチリレー(制御機能付)と単純な保護装置を使用。

Metalpartitioned single or double busbar system for all applications – even with the highest parameters. Cables accessible from the rear. All switching devices can be remote controlled and optionally mechanically inter-locked.

Both combined protection and control devices and pure protection devices are used.

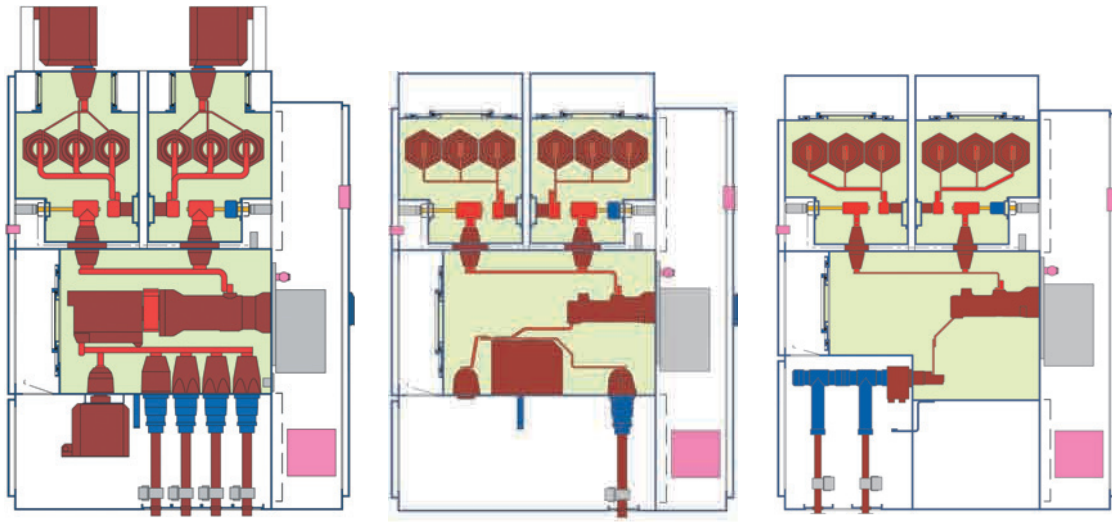

縮小型セクション盤による単母線構成
Single busbar arrangements with space saving bus sectionalizer panels

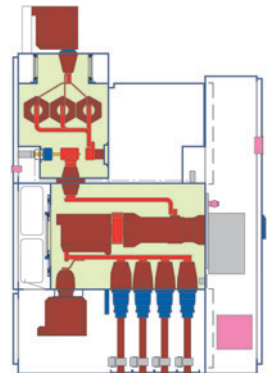
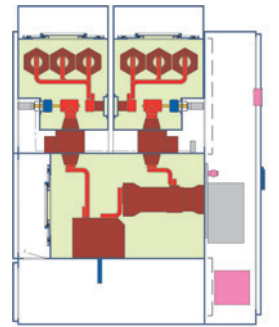
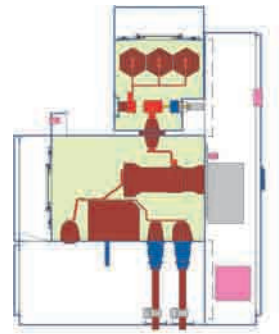

Ratings	IEC定格 IEC Ratings				特殊定格 Special	
	定格電圧 Rated voltage	kV	12/17.5	24	36	
最高使用電圧 Maximum operating voltage	kV	17.5	24	36	40.5	
耐電圧(商用周波/雷インパルス) Test voltages	kV	38/95	50/125	70/170	85/185	
定格周波数 Rated frequency	Hz	50/60	50/60	50/60	50/60	
定格母線電流 Rated busbar current	A	...2500	...2500	...2500	...2500	
フィーダーの定格電流 Rated current of feeder	A	630 1250 ...2500	630 1250 ...2500	1250 ...2500	1250 ...2500	
定格ピーク耐電流 Rated peak withstand current	kA	62.5 ...100	62.5 ...100	...100	...100	
定格短時間耐電流、3s Rated short-time current, 3s	kA	25 ...40	25 ...40	...40	...40	

ABB のパワーテクノロジー Power technology by ABB

ガス絶縁スイッチギヤ

産業及び電力分野の顧客がZXシリーズ製品を好んで選ぶのは、柔軟な組合せ、信頼性、有効性と経済性を兼ね備えているからです。

従来型の全ての機能に加えて、デジタル式保護と制御、センサーシステム、プラグイン式のケーブル接続がZXシステムの将来にわたる無限の拡張性をもたらし、不平や言い訳無しに一次側が信頼性の高い配電機能を実現します。

ABBの妥協のない品質への取組みが顧客の要望を確実に満たします。

Gas-insulated switchgear

Flexible combination, reliability, availability and economy are the attributes that make it easy for our clients in industry and utilities to decide in favor of products from the ZX series. Together with complete conventional solutions, the use of digital protection and control technology, sensor systems and plug-in connections makes ZX systems unrestrictedly fit for the future, and the primary function of reliable power distribution is fulfilled with no ifs and buts.

This is ensured by ABB's uncompromising approach to quality, which leaves no customer's wishes unfulfilled.



あらゆる状況に協力に対応

ZXファミリーはあらゆるチャレンジにソリューションを供給出来るよう、全ての要望に応えられる装備をもっています。70カ国以上の顧客がABBのガス絶縁スイッチギヤに信頼を寄せています。実績が証です。



A strong family for all situations in life.

Aligned to each need, the members of the ZX family offer a solution for each requirement. In over 70 countries the customers rely on the gas-insulated switchgears of the ABB. The selected references speak for itself...





ABB 株式会社
電力事業部

〒150-8512 東京都渋谷区桜丘町26-1
セルリアンタワー14階
Phone: 03-5784-6050
Fax: 03-5784-6277
Internet: <http://www.abb.co.jp>

ABB AG
Calor Emag Medium Voltage Products

Oberhausener Strasse 33 Petzower Strasse 8
40472 Ratingen 14542 Werder (Havel) OT Glindow
GERMANY GERMANY
Phone: +49(0)2102/12-0, Fax: +49(0)2102/12-1777
E-mail: powertech@de.abb.com
Internet: <http://www.abb.com/mediumvoltage>

Note:

We reserve the right to make technical changes or modify the contents of this document without prior notice. With regard to purchase orders, the agreed particulars shall prevail.

ABB does not accept any responsibility whatsoever for potential errors or possible lack of information in this document.

We reserve all rights in this document and in the subject matter and illustrations contained therein. Any reproduction – in whole or in parts – is forbidden without ABB's prior written consent.

Copyright © 2006 ABB AG

All rights reserved.

Druckschrift-Nr. DEABB/PT-FM 2349-EJ Gedruckt in Deutschland (05.06-2000-PC)