

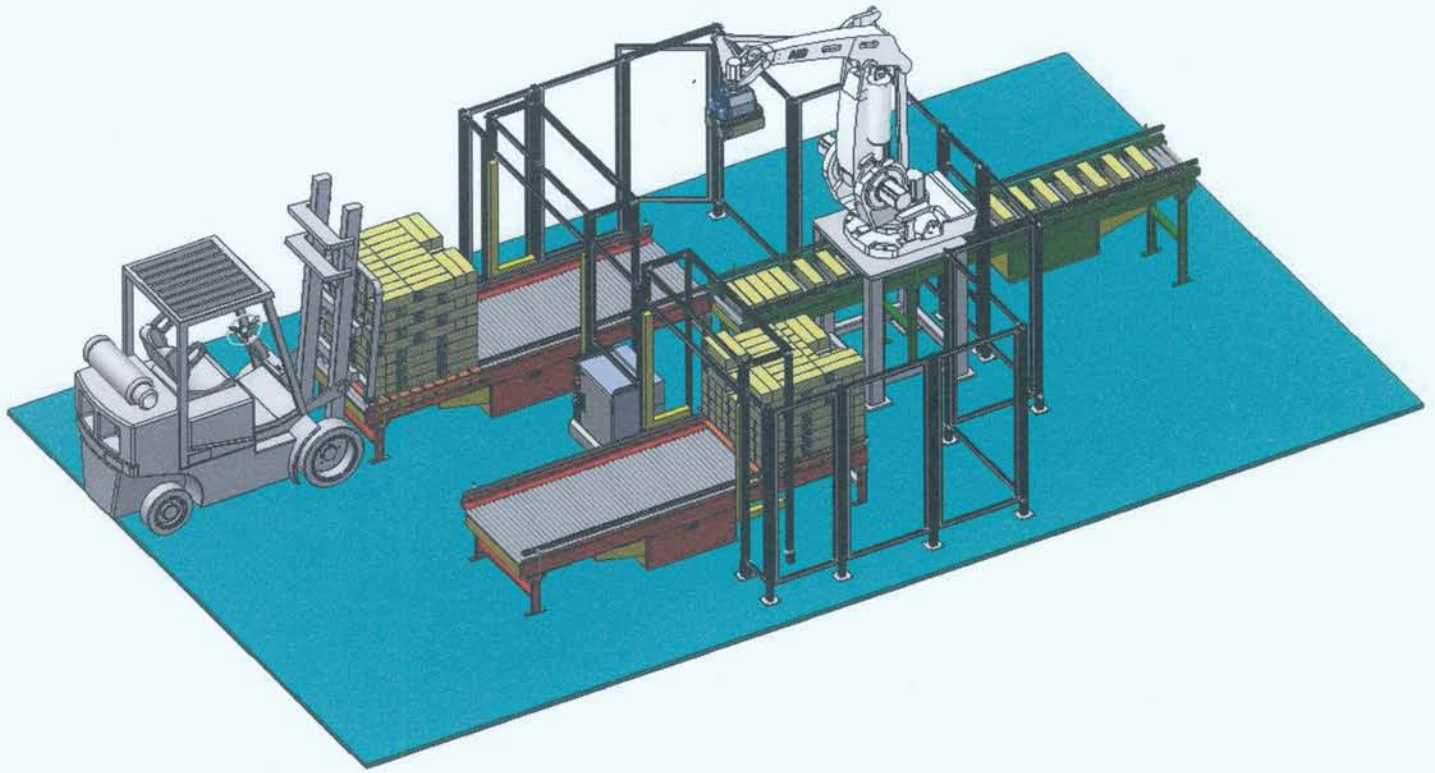

COMPACT PALLETIZING CELL WITH CONVEYORS

FLEXPALLETIZER™



Compact cell with conveyors boosts productivity

The CIM Flexpalletizer™ compact cell with conveyors is ideal for palletizing boxes, bags, pails, trays, bottles, and more. This robotic palletizing system can also handle slip-sheets, skee-sheets, and pallets. Its small footprint allows it to be effective in nearly any size facility.

The Flexpalletizer™ includes an ABB IRB 660 dedicated palletizing robot, which combines superior speed and reach with high payload capacity. The CIM Flexpalletizer™ compact cell can achieve throughput rates that approach those of hard-automated palletizers, with the advantage of robotic flexibility.

Compact cell advantages

- Product and pattern flexibility
- Fast change-over time
- Short delivery time
- Fast and easy installation
- High uptime and capacity
- Extremely easy operation
- Low maintenance
- Lowest hourly cost
- Lowest cost per layer at every capacity interval
- Extremely short payoff time
- ABB/CIM SYSTEMS experience and service organization

Pricing for the compact cell with conveyors starts at \$150,000



COMPACT PALLETIZING CELL WITH CONVEYORS

FLEXPALLETIZER™

Technical Specifications

Primary Cell Components

- 1) ABB IRB 660 robot



- 1) IRC5 robot controller

- 1) Robot riser



- 1) Dual-box vacuum pad gripper



- 1) Valves and sensors
- 1) Robot cable protection
- 1) In-feed conveyor with sensors
- 2) Pallet conveyors with sensors
- 1) Perimeter fencing with door
- 2) Muting light curtains

Physical

Cell footprint	16'W x 20'L x 12'H
Robot weight	3,630 pounds [1650 kg]
Pallet size	Up to 48" x 48"

Performance

Payload Capacity	396 pounds [180 kg]
Repeatability	0.004" [0.1mm]
Path repeatability	0.012" [0.3mm]

The compact cell can palletize at the following rates:

- Up to 28 boxes per minute
- Up to 22 bags per minute
- Up to 24 pails per minute

Safety

The compact cell is surrounded by perimeter fencing that meets or exceeds all OSHA, RIA, and ANSI specifications. The extruded-aluminum posts and frames are powder coated for a tough, long-lasting finish. Your choice of PVC-coated wire mesh or Lexan is used to keep personnel out of the robot work area. Fencing panels can easily be removed for maintenance.

Two muting light curtains are used to ensure finished product can exit the cell, while offering protection against anything entering the cell. A safety-rated gate plug ensures the robot will stop if the maintenance door is opened.

Services

CIM SYSTEMS Robotics, one of ABB's top integrators worldwide, offers turn-key engineering, installation and support:

- Lead engineering
- Electrical engineering and prints
- Mechanical engineering and prints
- Runoff with customer product at CIM
- On-site installation supervision
- On-site programming
- On-site operator training