

3.7 EST and HEST Shuttler/Turnover Tooling

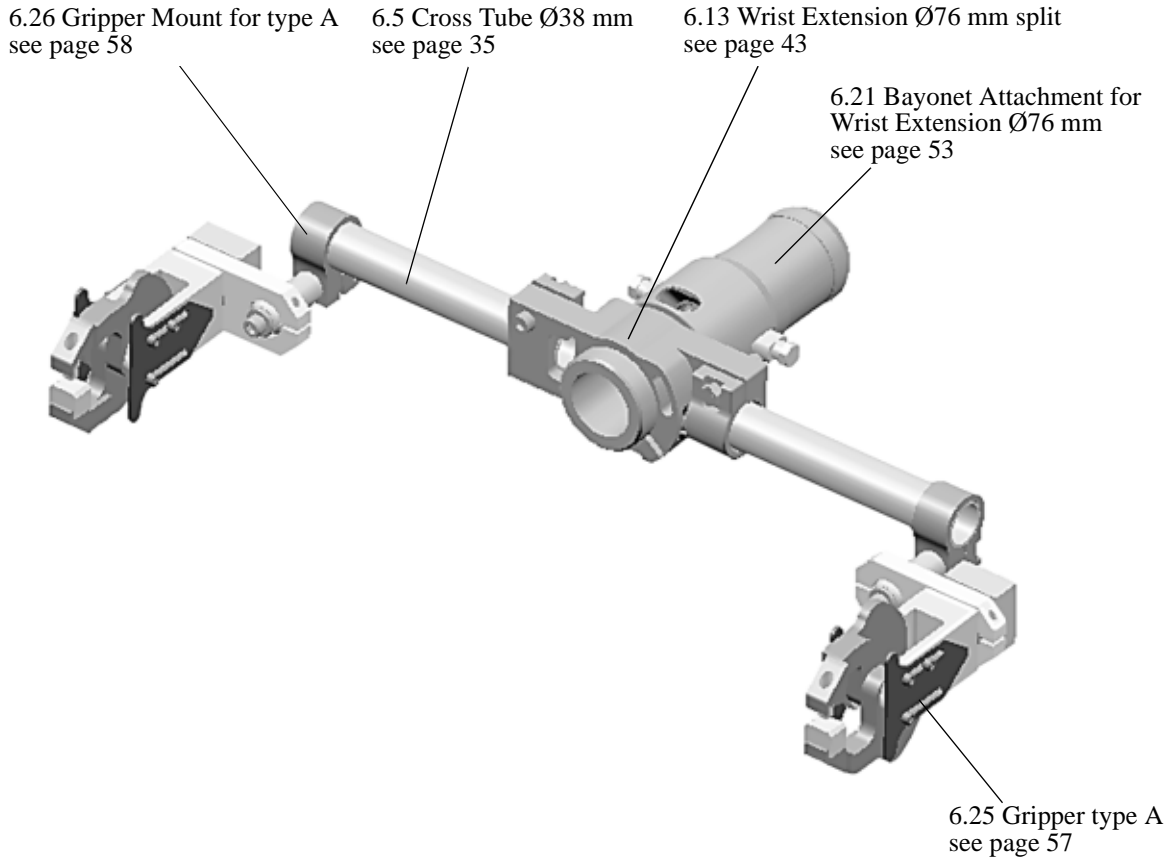

3.8 EST and HEST Shuttler/Turnover Tooling

6.20 Part Localisers for
Lower Tooling
see page 52

6.13 Wrist Extension Ø76 mm split
see page 43

6.21 Bayonet Attachment for
Wrist Extension Ø76 mm
see page 53

