

FlexArc® 500C MultiMove™ Cell

Global Arc Welding Production Solution

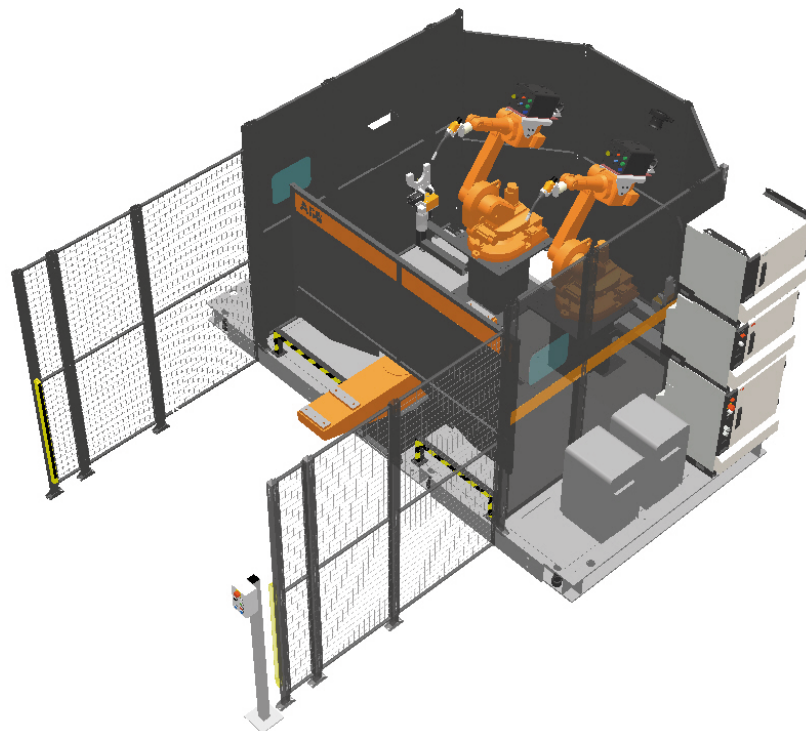

A complete range of fully integrated, standardized welding cells

FlexArc robotic welding cells are complete robot systems available in several flexible and versatile, standard modular packages. The cells are delivered ready to weld.

Flexibility

If new parts are modified, added or specifications change, fixtures can be changed or modified on one station or both. The robot can either weld new or different parts and maintain maximum flexibility of the cell.

Each of ABB's FlexArc Cells are available in virtual format as identical replicas of the actual in Robot-

Studio and can be programmed offline on a personal computer.

Based on our marginal production solutions ABB has standard versions to meet your needs.

Reusability

FlexArc cells have produced millions of parts since their introduction and are industry accepted and proven solutions.

High Productivity

FlexArc cells are standard, pre-engineered solutions designed to permit quick, efficient set-up so you are running production in minutes instead of days.

FlexArc® 500C MultiMove™ Cell

Global Arc Welding Production Solution

TECHNICAL DATA

THE 500C/1000C CELL FEATURES

Two IRB 1600 robots integrated with the IRBP 500C 180° index positioner
 Perimeter guarding which complies with ANSI/RIA 15.06/1999
 Man/Machine (HMI) Interface
 Welding power supply
 Robotic welding torch (air cooled or water cooled)
 Robotic torch cleaner/ dresser
 Metal mounting base (transportable with fork lift pockets)
 Operator present sensing device
 Cables are completely integrated into base of the cell
 Cell door interlock device
 Optional fume extractor

SPECIFICATION

Handling capacity Per Side (Station)	500 Kg/1102 lb.
Max Inertia	880 Kgm ²
Max Bending torque	5000 Nm
Min interchange time	3.3 seconds
Max interchange time	4 seconds
Repeatability (r=500)	0.1 mm
Max load diff	350 kg/770 lb.
Max tool length (From center)	1250 mm
Optional Equipment	Torch Service Center Incl. BullsEye™, SmarTac™, Fume Hood (incl. lighting), Thru-Arc Seam Tracking, Offline Programming Software, Virtual FlexArc™
Cell Dimension Total plant Floor Foot print	Length (188.5" / 4790mm) X Width (168" / 4267mm)

500C INDEXES 180 DEGREES



TYPICAL PRODUCTION CYCLE DESCRIPTION

Operator unloads and loads one fixture while the robot welds on the second fixture. When both the operator and robots have completed their operations, the positioner indexes and cycle starts again.

CELL LAYOUT: TOP VIEW

